

Alternator - 16 ACR 12 Volt 34 Amp Machine Sensed
2.3 Litre Diesel Engine Suffix 'A'

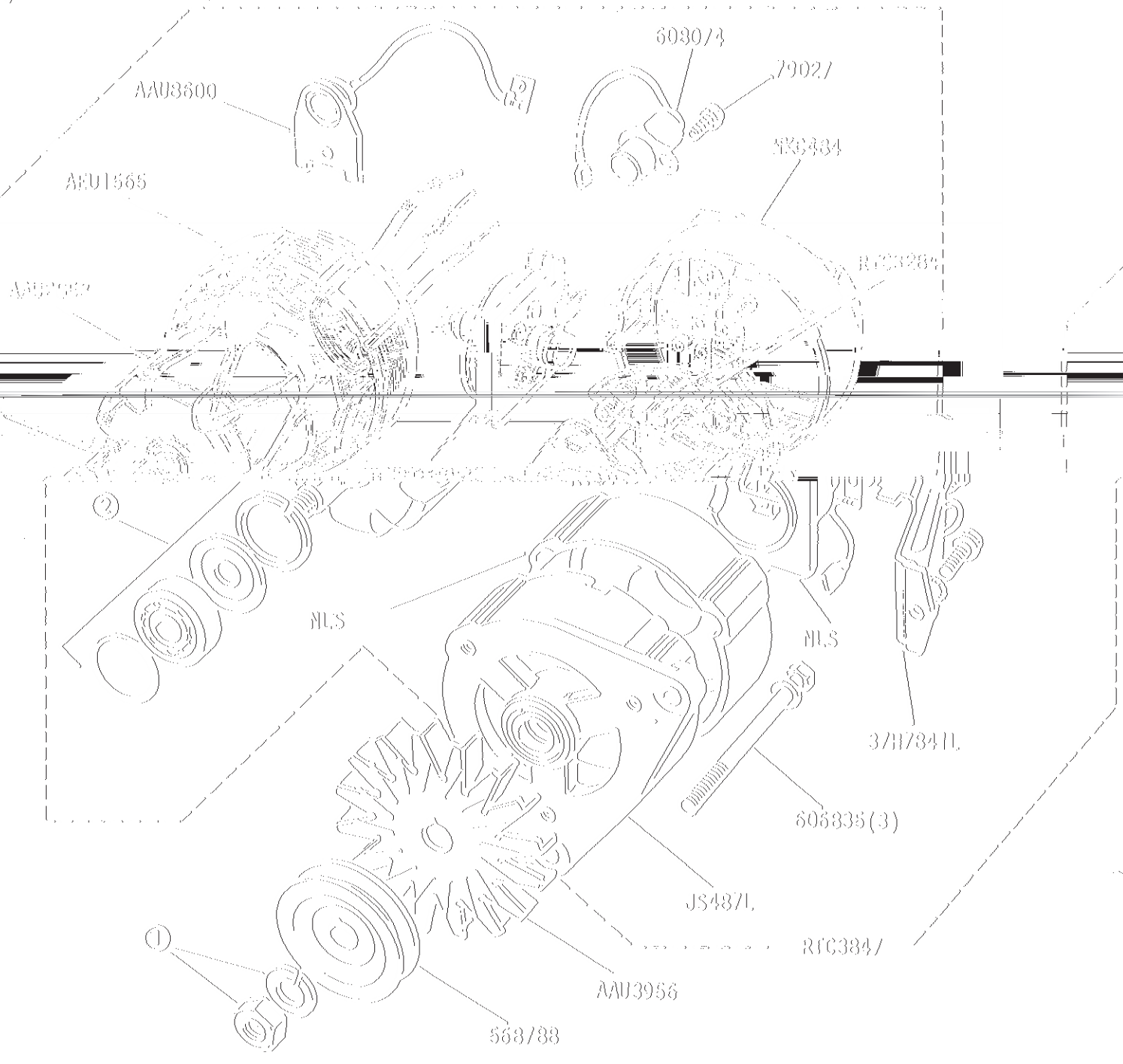

- ① Sundry Parts Kit JS495L
- Bearing Kits
- ② Slip Ring End 18G8620L
- Drive End 18G8619L 35mm
- Drive End 518848 42mm

Alternatives

GROUP K

ENGINE - Alternator - 16ACR 12 Volt 34 Amp Battery Sensed 2½ Litre Diesel

From Engine Suffix
'B' onwards

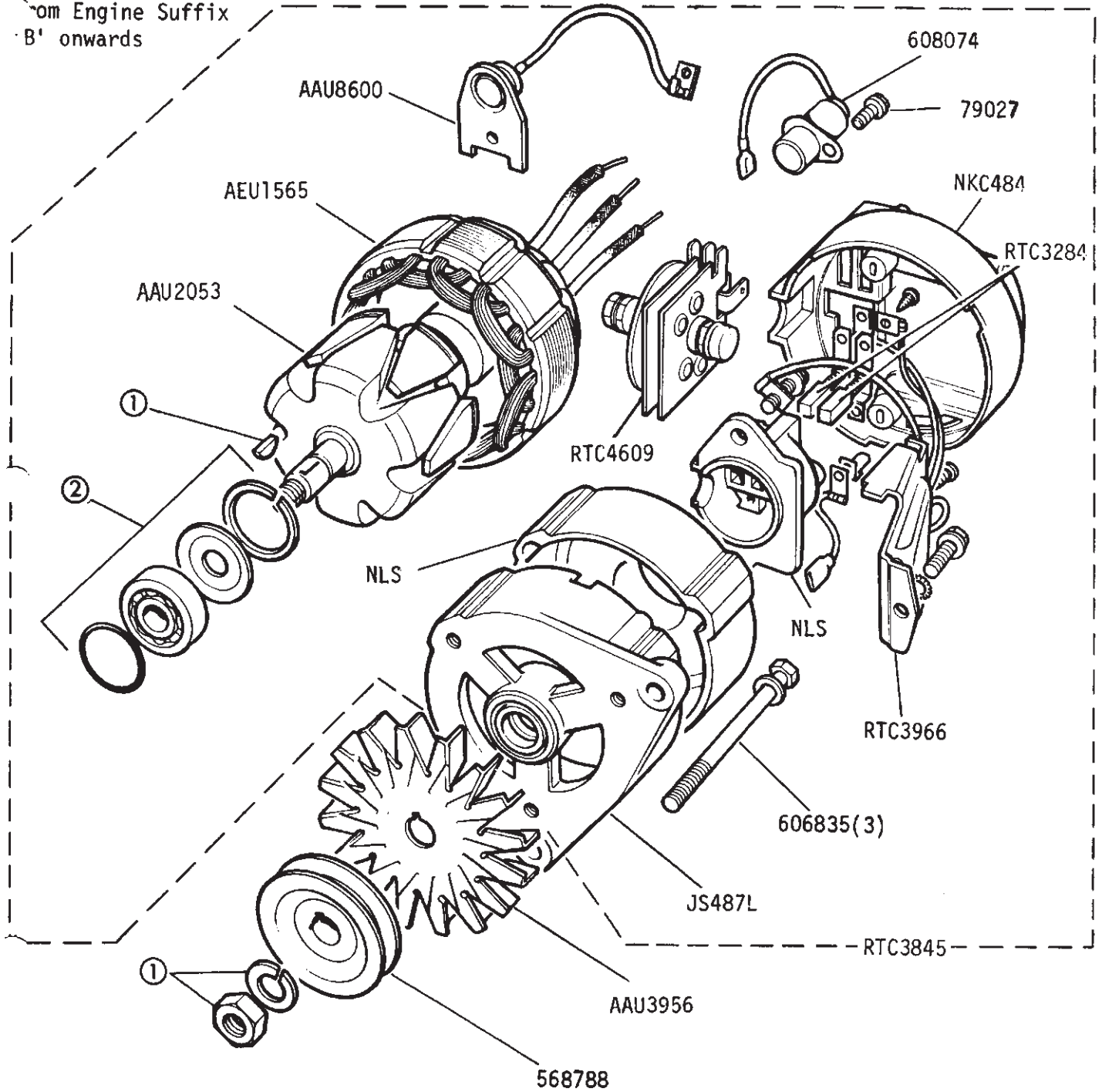

① Sundry Parts Kit JS495L

Bearing Kits:-

② Slip Ring End 18G8620L

Drive End 18G8619L



LAND ROVER

2E 14

3RE414